



# axkid

## Instruction manual

### Rekid



Rear-facing 9-18 kg  
installed with ISOfix

Rear-facing 9-25 kg  
installed with vehicle seat belt

Tested and approved according to

**ECE R44 / 04**

ISOfix size C/R3

# Important information

Thank you for choosing an Axxkid child seat. Our team combined have over 30 years experience within child safety, and we have done our utmost to make the Rekid child seat as safe as possible. The Rekid child restraint is approved according to ECE R44/04, the latest European standards for child safety. To maximise your child's safety it is important that you keep the following in mind;

- Read this instruction manual carefully before installing the Rekid child restraint. If in doubt, contact your retailer who can demonstrate a correct installation. An incorrect installation could endanger your child.
- Do not use a child restraint in a seating position where an active airbag is fitted. If you still wish to install the Rekid in this location the airbag must be disconnected at an authorised service centre. Some vehicles may be equipped with a switch which allows you to manually switch the airbag off. It is important to always check if the vehicle's indicator light shows that the airbag is turned off.
- Extensive research has shown that the risk of serious injury or worse is five times greater for a young child when in a forward facing restraint compared to a rearwardfacing restraint. In Rekid your child can travel rearwardfacing up to 25kg.
- Always use the support leg when installing the Rekid seat. The support leg is a very important safety feature designed to maximise your child's safety in an accident.
- Should you have an accident, no matter how small, your child restraint should be replaced. It may have damage that is undetectable and could seriously jeopardize your child's safety. For this reason Axxkid do not recommend purchasing second hand child restraints.



Read this instruction manual before installing the Rekid child restraint in your vehicle.

# Contents

The Rekid child restraint is suitable for use from approximately six months of age, or from when your child can sit up unsupported, up until the age of six. This child restraint can be installed in two different ways depending on your child's age and size. A description of the Rekid's different parts can be found on next page. On the following pages you will find instructions on how to install your Rekid. Our Rekid child restraint is certified and approved for use;

## **Rearfacing 9-18 kg installed using ISOfix**

5

If your vehicle is equipped with ISOfix brackets and your child weighs between 9-18 kg (20-39 lb) Axkid recommends using this installation.

## **Rearfacing 9-25 kg installed with vehicle belt**

11

If your vehicle is not equipped with ISOfix brackets you can still install Rekid using vehicle's lap-only or lap-diagonal seat belt and supplied tether straps.



Do not use the Rekid child restraint in seating locations that are not equipped with approved three-point seat belts (according to ECE Reg 16.)

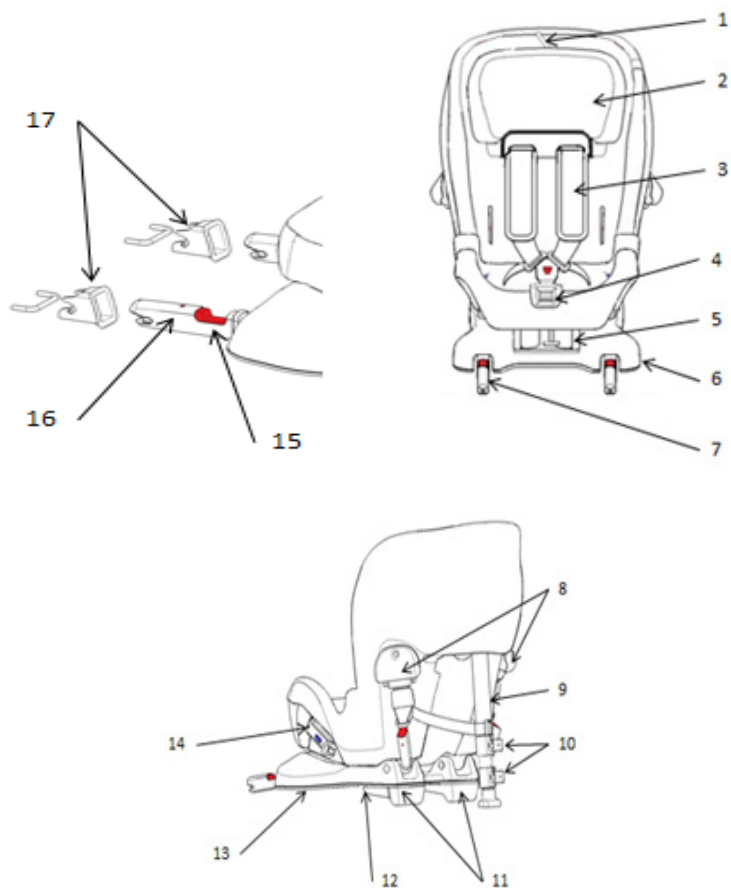

1. Parking brake neckrest

2. Adjustable Headrest

3. Internal harness

4. Harness adjustment button

5. Recline adjustment lever

6. Base

7. ISOFIX arms

8. Upper tether/anchorage straps

9. Support leg

10. Adjustors for support leg

11. Heels

12. Pocket for storage of instruction manual

13. Adjustor for ISOfix

14. Belt lock-off

15. Release button Isofix

15. Indicator Isofix

17. Guides for installation

# Installing Rekid rear-facing 9-18kg using ISOfix

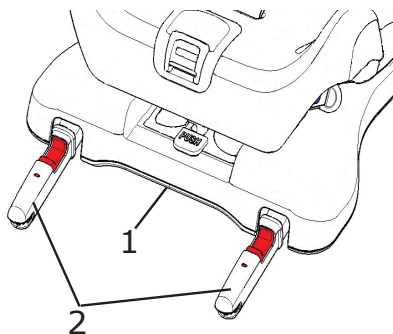

## Important to remember

Do not use a child restraint in a seating position where an active airbag is fitted. If you still wish to install your Rekid in this location the airbag must be disconnected at an authorized service centre. Some vehicles may be equipped with a switch which allows you to manually switch the airbag off. It is important to always check if the vehicle's indicator light shows that the airbag is turned off.



## Placing the child restraint

The easiest way to lift the Rekid into the vehicle is with its back first. To begin push and hold the adjuster for ISOfix(1). Now you should be able to unfold the ISOfix arms (2). Place the child restraint in the vehicle with the back of the restraint facing the front of the vehicle. When installing Rekid in the front seat it is possible, but not crucial, for the back of the restraint to have contact with the dashboard.

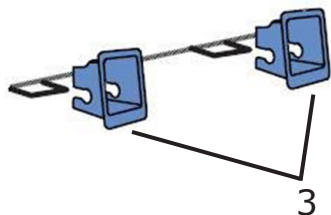

## Attaching the ISOfix fittings

The ISOfix brackets are located in the bight of the back seat between the backrest and seat. The supplied ISOfix-guides (3) may assist you in locating these brackets, and they will also help protecting the vehicle's upholstery. Push the ISOfix fittings through the guides and clip them onto the brackets.

*Continued on next page*



**Never install a child restraint in a passenger seat where an active airbag is fitted**

Once there is an audible click and both indicators (4) are green they are properly secured. To remove the Rekid child restraint, hold both of the release buttons (5).

To adjust the angle of the child restraint, press the Recline Adjustment Lever (6) to select one of the three reclining positions. Always choose the most upright position as possible, however your child must be able to hold their head up on its own, and there should be enough recline to ensure your child's head does not fall forward when sleeping. The rule of thumb is that the older the child grows, the more upright the seat can be installed. Please note that once the installation of the Rekid is complete, it will be somewhat more reclined as it sinks into the vehicle's seat when tightening seat belts and tether straps.

### **Attaching the lower tether straps**

Some vehicles may already be fitted with anchorage points at the base of the front seat rails.

If your vehicle does not have these anchor points, the supplied lower tether straps must be used to create anchor points. For tips on how to install these tether straps please see the example on the next page.

The anchoring point needs to be as close to the floor as possible. In doing so you should always insert the buckle through the closest appropriate slot in the strap to create a slip knot and pull tight. This

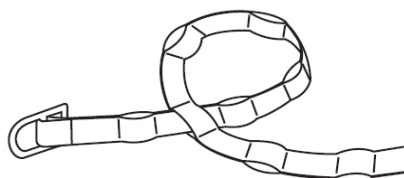
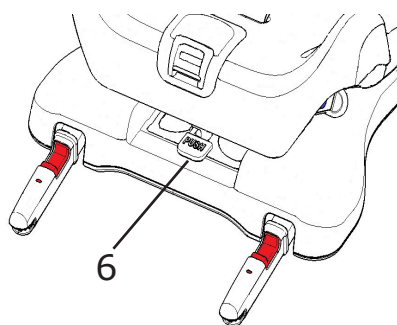
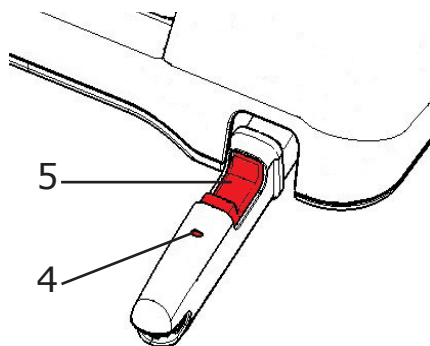

**Lower tether straps**

*Continued on next page*

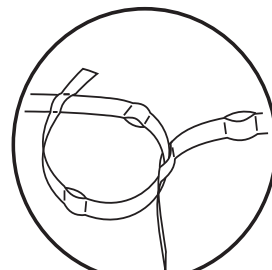
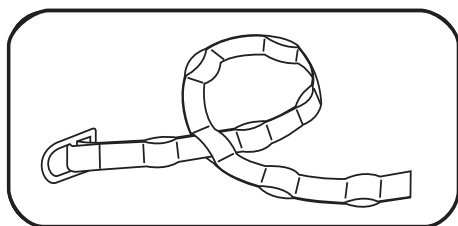
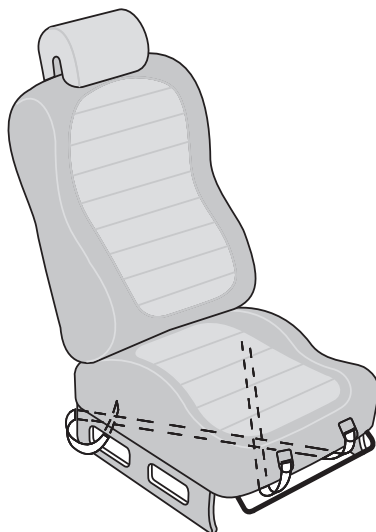

*Continued on next page*

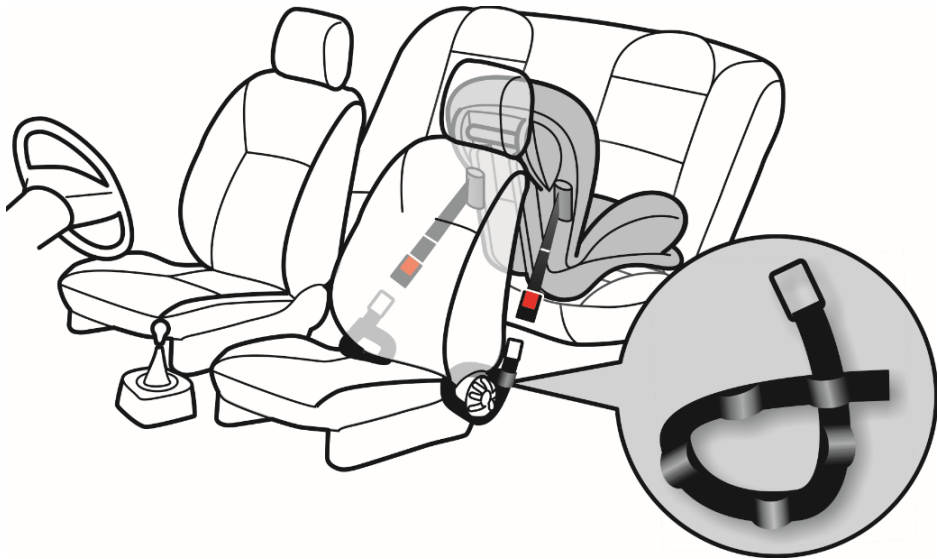
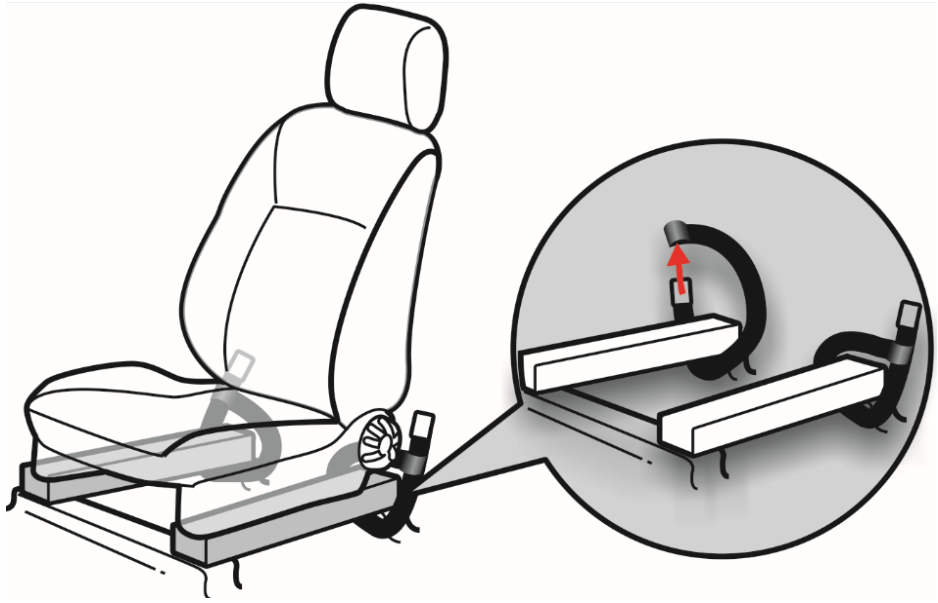

*Continued on next page*

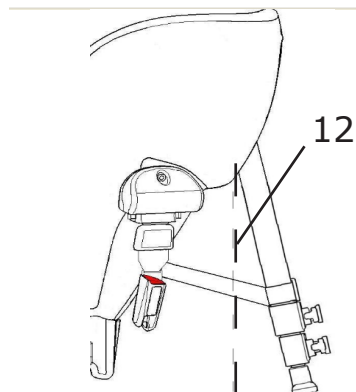
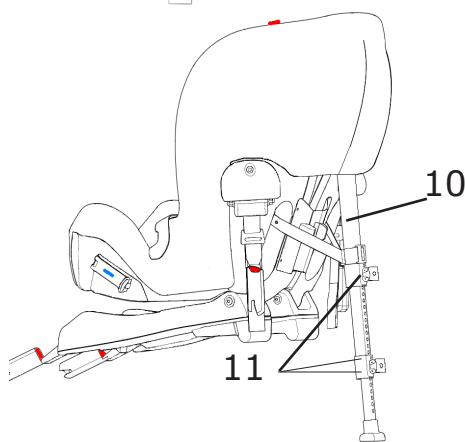
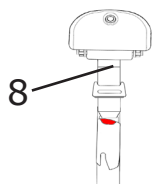
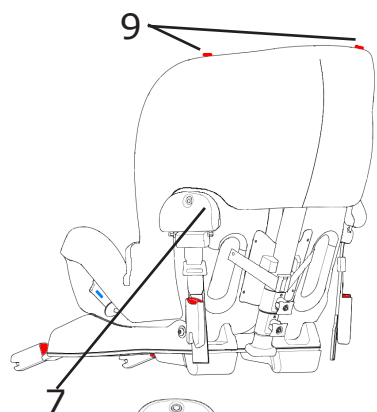

needs to be repeated on both sides to create two anchor points. When installing Rekid in the front passenger seat the tether straps must be attached to the front gliding tracks so the tether points will be located along the front edge of the passenger seat. Pull out the upper anchorage strap from the belt housing (7) to an appropriate length. Check that the white marking on the strap (8) is visible. If not, you can try crossing the straps over to give them some extra length to enable the white marking to be visible. Clip the anchor attachment directly onto the anchorage point. Repeat on the other side. Press down hard on the on the top right side of the child restraint then repeat for the left side(9). When you do this its important that you really use your full body weight to press down and get the tether straps to really tighten hard. This will give the anchorage straps their first tightening.

Unfold the support leg (10) out to its maximum angle. Pull out the top latch to release the upper part of the support leg (11) until it reaches the floor. If the support leg does not reach the floor, repeat with the lower latch (11). Its important that you check that the support leg is an angle over 80 degrees from the back of the seat. You could check this by ensuring that the support leg is further away from the seat then the vertical line(12). Press down on the child restraint from side to side again, the anchorage straps will be then be automatically tightened.

*Continued on next page*

If you have installed Rekid in the back seat you can now move the front seat to a comfortable position. The back of the child restraint can, but is not necessary, be in contact with the back of the front seat.

### Adjusting the internal harness

Place your child in the car seat. Put your child's arms in between the shoulder straps so that the straps are hanging over the chest and stomach. Pull the shoulder straps together and insert the harness tongues into the crotch buckle. Push the harness up over the child's hip. Pull the harness adjustment strap (13). It's important that you always pull the harness straight and central. Otherwise you might have a that the adjustment strap gets stuck in the metall-lever(13). This action will tighten the harness and the headrest will automatically slide down to the appropriate height. To release the harness, press the harness adjustment button and pull both harness straps. Press the red button on crotch buckle to disengage buckle.

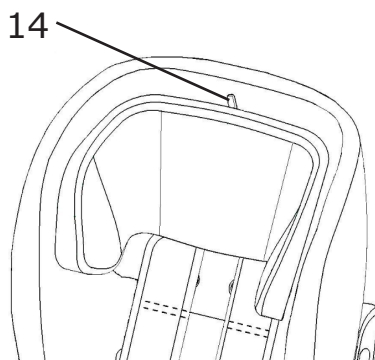
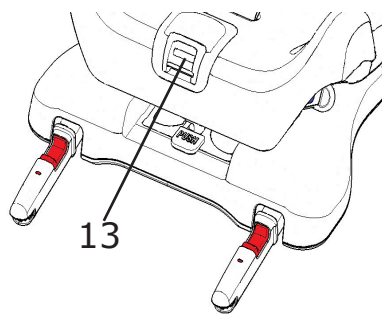
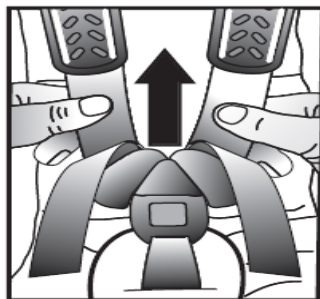

### Parking brake on headrest

The headrest on your Rekid is equipped with a parking brake. This could be used if you want the headrest in a fix position. To activate the parking brake, pull the harness until the headrest is at the desired height, you will hear a "click" sound from the headrest as it locks into position. Make sure that the headrest can not be pulled down. Activate the brake by moving the lever (14) on the headrest across to the right. Do not pull up the headrest with the parking brake activated.

# Rearward facing fastened with seat belt



## Important to remember

Do not use a child restraint in a seating position where an active airbag is fitted. If you still wish to install your Rekid in this location the airbag must be disconnected at an authorized service centre. Some vehicles may be equipped with a switch which allows you to manually switch the airbag off. It is important to always check if the vehicle's indicator light shows that the airbag is turned off.

## Placing the child restraint

The easiest way to lift the Rekid into the vehicle is with its back first. Place the child restraint in the vehicle with the back of the restraint facing the front of the vehicle. The heels (1) should be sitting over the edge of the vehicle seat. The indented vertical line on the heel should align vertically with the end of the vehicle's seat.

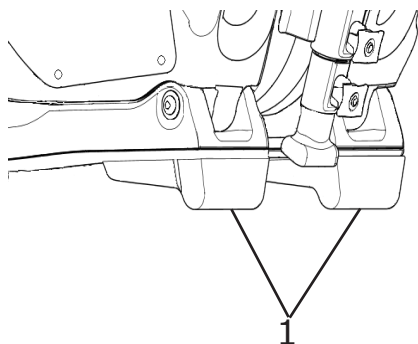

If installing in a small vehicle, or if your child does not require extra leg room, you can instead place the heel upon the vehicle's seat this will also achieve a more reclined position. When installing Rekid in the front seat it is possible, but not crucial, for the back of the restraint to have contact with the dashboard.

To adjust the angle, press the Recline

*Continued on next page*



**Never install a child restraint in a passenger seat where an active airbag is fitted**

Adjustment Lever (2) to select one of the three reclining positions. Always choose the most upright angle as possible, but there should be enough recline to ensure your child's head does not fall forward when sleeping. The rule of thumb is that the older the child grows, the more upright the seat can be installed. Bear in mind that once the installation of the Rekid is complete, it will be somewhat more reclined as it sinks into the vehicle's seat from tightening seat belts and tether straps.

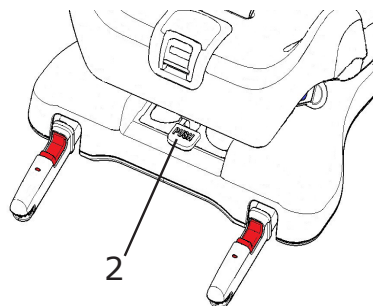

### **Fastening the vehicle seat belt**

Open the lock-offs (3) on both sides of the Rekid child restraint. Fully lengthen the seat belt until the lap section of the belt is at least 70-80 cm (27-32 inches) long. Feed the seat belt between the seat cover and seat body through the seat belt slot (4) until the belt comes out through the opening on the other side. If you prefer, you can instead feed the seat belt over the top of the seat belt cover. Engage into the vehicle's seat belt buckle. Pull seat belt until all slack is removed along the seat belt route. Then secure both the lap and shoulder belt in the lock-off closest to the vehicle's seat belt buckle. In the lock-off on the opposite side, only the lap belt should be secured.

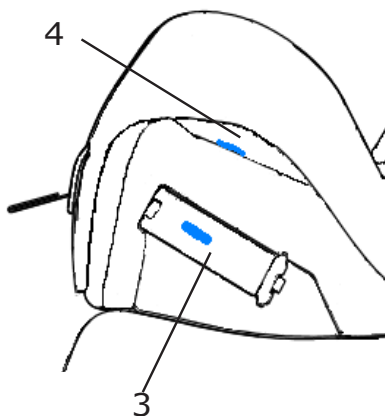

### **Attaching the lower tether straps**

Some vehicles may already be fitted with anchorage points at the base of the front seat rails, or, if installing in the front passenger seat, in front of that seat. If your vehicle does not have these anchor points, the supplied lower tether straps must be used to, see pages 7-8 for example. For installation in the back seat, feed the buckle end of the tether strap through either the rear of the front seat rails, or the hinge of the front seat. The

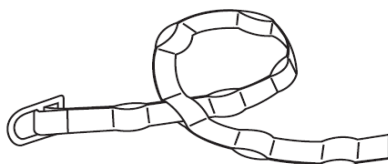

**Lower tether straps**

*Continued on next page*

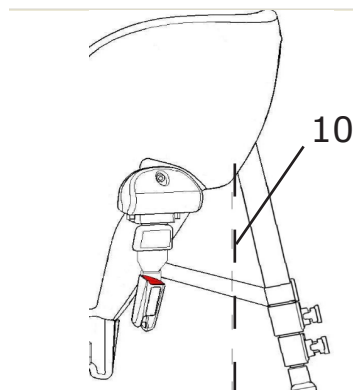
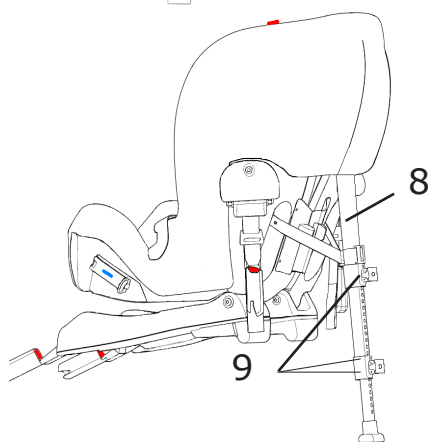
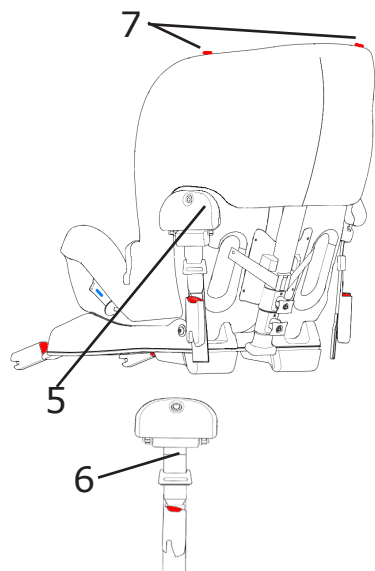

anchoring point needs to be as close to the floor as possible. In doing so you should always insert the buckle through the closest appropriate slot in the strap to create a slip knot then pull tight. This needs to be repeated on both sides to create two anchor points. When installing Rekid in the front passenger seat the tether straps must be attached to the front gliding tracks so the tether points will be located along the front edge of the passenger seat.

Pull out the upper anchorage strap from the belt housing (5) to an appropriate length. Check that the white marking on the strap (6) is visible. If not, you can try crossing the straps over to give them some extra length to enable the white marking to be visible. Clip the anchor attachment directly onto the anchorage point. Repeat on the other side. Press down hard on the top right side of the child restraint then repeat for the left side (7). When you do this it's important that you really use your full body weight to press down and get the tether straps to really tighten hard. This will give the anchorage straps their first tightening.

Unfold the support leg out to its maximum angle. Pull out the top latch to release the upper part of the support leg (8) until it reaches the floor. If the support leg does not reach the floor, repeat with the lower latch (9). It's important that you check that the support leg is at an angle over 80 degrees from the back of the seat. You could check this by ensuring that the support leg is further away from the seat than the vertical line (10).

Press down on the child restraint from side to side again, the anchorage straps will then be automatically tightened.

*Continued on next page*

If you have installed Rekid in the back seat you can now move the front seat to a comfortable position. The back of the child restraint can, but is not necessary, be in contact with the back of the front seat.

### Adjusting the internal harness

Place your child in the car seat. Put your child's arms in between the shoulder straps so that the straps are hanging over the chest and stomach. Pull the shoulder straps together and insert the harness tongues into the crotch buckle. Pull the harness adjustment strap (11). It's important that you always pull the harness straight and central when you tighten the adjustment strap. This will tighten the harness and the headrest will automatically slide down to the appropriate height. To release the harness, press the harness adjustment button and pull both harness straps. Press the red button on crotch buckle to disengage buckle.

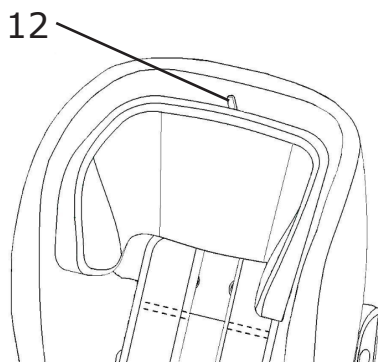
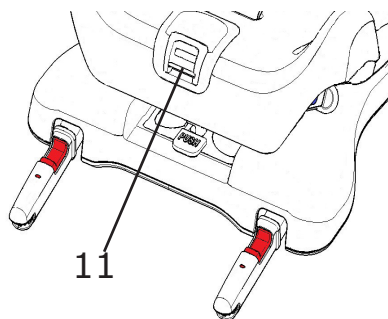
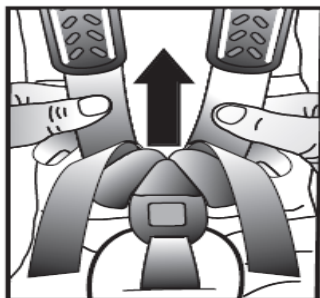

### Parking brake on headrest

The headrest on your Rekid is equipped with a parking brake. This could be used if you want the headrest in a fix position. To activate the parking brake, pull the harness until the headrest is at the desired height, you will hear a "click" sound from the headrest as it locks into position. Make sure that the headrest can not be pulled down. Activate the brake by moving the lever (14) on the headrest across to the right. Do not pull up the headrest with the parking brake activated.

## Warranty and handling

If the seat cover needs replacing ensure only original products from Axon Kids are used. If other products are used the Rekid's safety system may be compromised and could lead to severe injury or death in case of an accident.

The seat cover can be removed and washed in a washing machine at 30° C on the "Gentle Cycle" programme. Do not put the cover in a dryer as this can damage the cover and the padding may separate from the fabric. On [www.axkid.com](http://www.axkid.com) you could find videos explaining how to deattach and attach the clothing.

Any plastic parts of Rekid can be cleaned with mild detergent and water. Do not use aggressive chemicals containing solvents etc, as this can cause damage to the plastic and compromise the safety of the child restraint.

All materials used in the Rekid child restraint are recyclable and should be recycled as per your local legislation. Ask your local recycling centre for advice when recycling this product.

Do not make any modifications or alterations to the Rekid child restraint other than those described in this instruction manual. Follow the instructions in this manual carefully. Any repairs must be carried out by the manufacturer or agent.

The Rekid child restraint is covered by a 12 month warranty from date of purchase. Ensure you save your receipt and bring it to your place of purchase should you have any warranty issues. The warranty does not cover:

- \* Normal wear and tear
- \* Damage due to incorrect use, neglect or accident
- \* If repairs have been carried out by a third party

All materials used have a very high UV-resistance rating. However, UV-light is very aggressive and will ultimately lead to fading of the seat cover. This is not covered by our warranty as it is considered normal wear and tear.

Never leave your child unattended in the car.

Ensure any luggage or loose objects are secured in your vehicle as they may cause injuries to passengers in the event of a collision.

Store this instruction manual in the assigned pocket underneath the child restraint.